

FULL OVERLAY

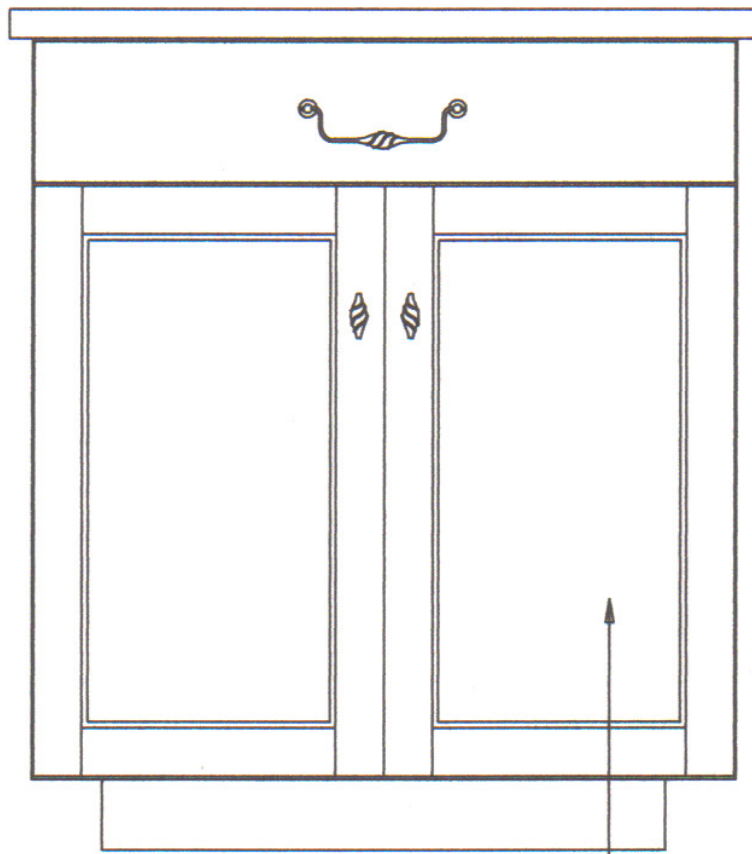

DOOR COVERS ENTIRE FRAME

THE DOOR & DRAWER HEADS ARE PLACED ON TOP OF THE FRAME & MADE LARGE ENOUGH TO COVER THE ENTIRE CABINET FRAME. DOOR EDGES ALMOST TOUCH EACH OTHER.